

# Project Type: Office

Renovation, Tenant Improvement & Adaptive Reuse

**Project:** Relocation of Harte Hanks  
**Client:** Harte Hanks/Equity Industrial Partners  
**Location:** 600 N. Bedford St., East Bridgewater, MA  
**Size:** 223,000 SF (2 Floors)

## Project Description:

Cramer Levine was hired by Equity Industrial Partners to complete space planning/feasibility studies to verify that the buildings in question were large enough and worked for Harte Hanks. After extensive studies of these two buildings the tenant decided to move into one of the buildings totaling 223,000 sqft of the available 342,000 sqft. During the feasibility study our firm developed a positive relationship with the tenant, therefore when the time came to produce the contract documents for their space we were asked to carry out the work. We worked closely with all the department heads and executives to ensure a smooth transition from their previous location to their newly renovated facility.

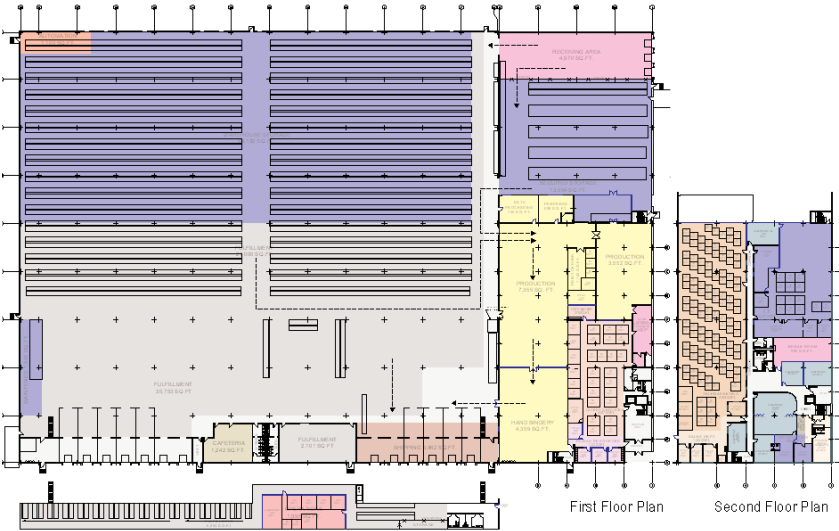

## Program Study

	Large Office 10 x 12	Small Office 10 x 10	Large Workstation 12 x 12	Medium Workstation 8 x 8	Small Workstation 2 x 6	Conference room - Large 20 x 12	Conference room - Medium 12 x 12	Conference room - Small 12 x 10	Area of Department
Warehousing									59,182
Operations	1	8	2						1998
Secured Storage									13,504
Automation									1500
Receiving									4870
Shipping									3802
Maintenance Area									1500
Fulfillment									
Open area									37804
Backlog area									27000
Mezzanine									6503
Print Center									17860
raw materials									
digital/printers									
production									
hand binding									
Office	3	3	3						
Reception Room									
Data Processing									800
Breakroom									500
Cafeteria									1242
General Office									
Telemarketing	3		7	110					9552
IT	1		4	14					5741
Computer Room									
Storage Closet									
Training Lab									
Client Services	1	6	14	12					4927
Copy Center									
Storage									
Human Resources	1	3							1102
Flairroom									
Accounting	1	2							690
Quality	1	2							390
Sales	2								1168
President/General Manager's Office									437
Conference Rooms						1	2	3	
Large Conference									1230
Medium Conference									493
Medium Conference									460
Small Conference									390
Small Conference									360
Small Conference									360
Sub Total									206180
Common Area									
Warehouse									11477
First Floor									12707
Second Floor									3010
Grand Total									222973

