

Project Type: Office

Tenant Improvement

Project: CCS Companies
Client: CCS Companies, USA
Location: 15 Southwest Park, Westwood, MA
Size: 40,600 SF (2 Floors)

Project Description:

This project involved space planning for CCS Companies departments on two floors. Tasks included redistribution of office space to address new adjacencies and operational requirements within departments. The project also consisted of refinishing and updating the existing lobby and reception area.

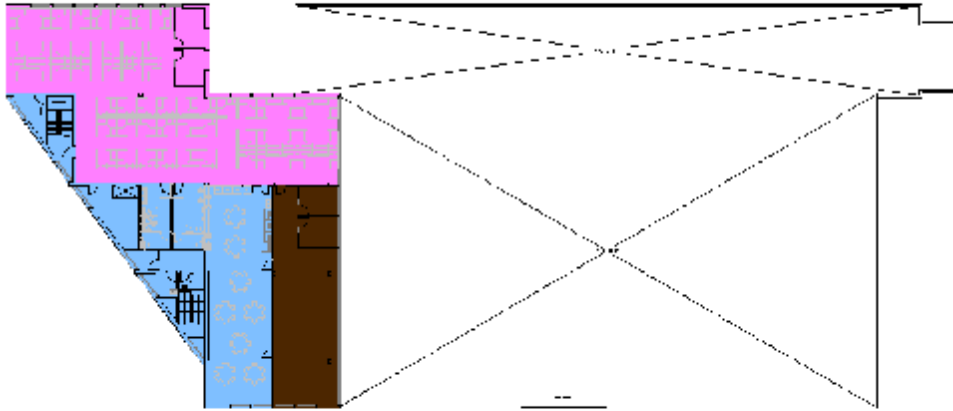

Second Floor



First Floor

